

E-FLANGE INPUT

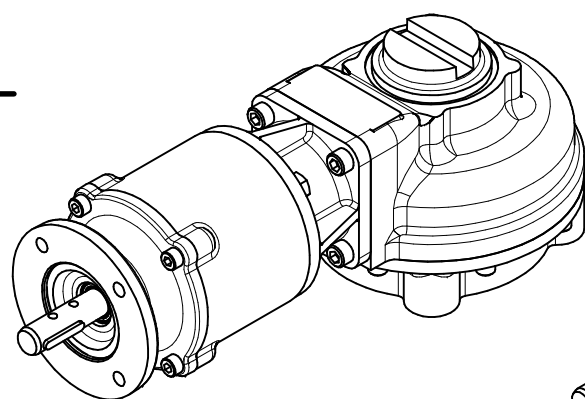

E-FLANGE INPUT  
ISOMETRIC VIEW  
1:5

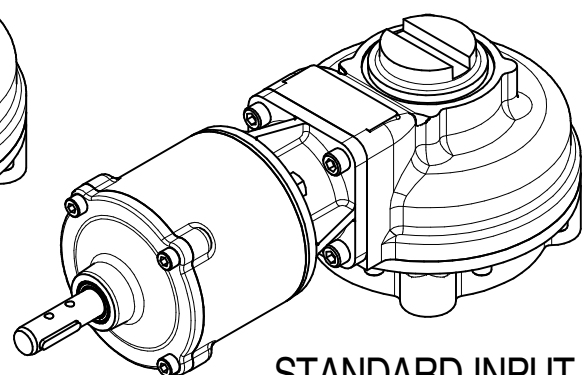

STANDARD INPUT  
ISOMETRIC VIEW  
1:5

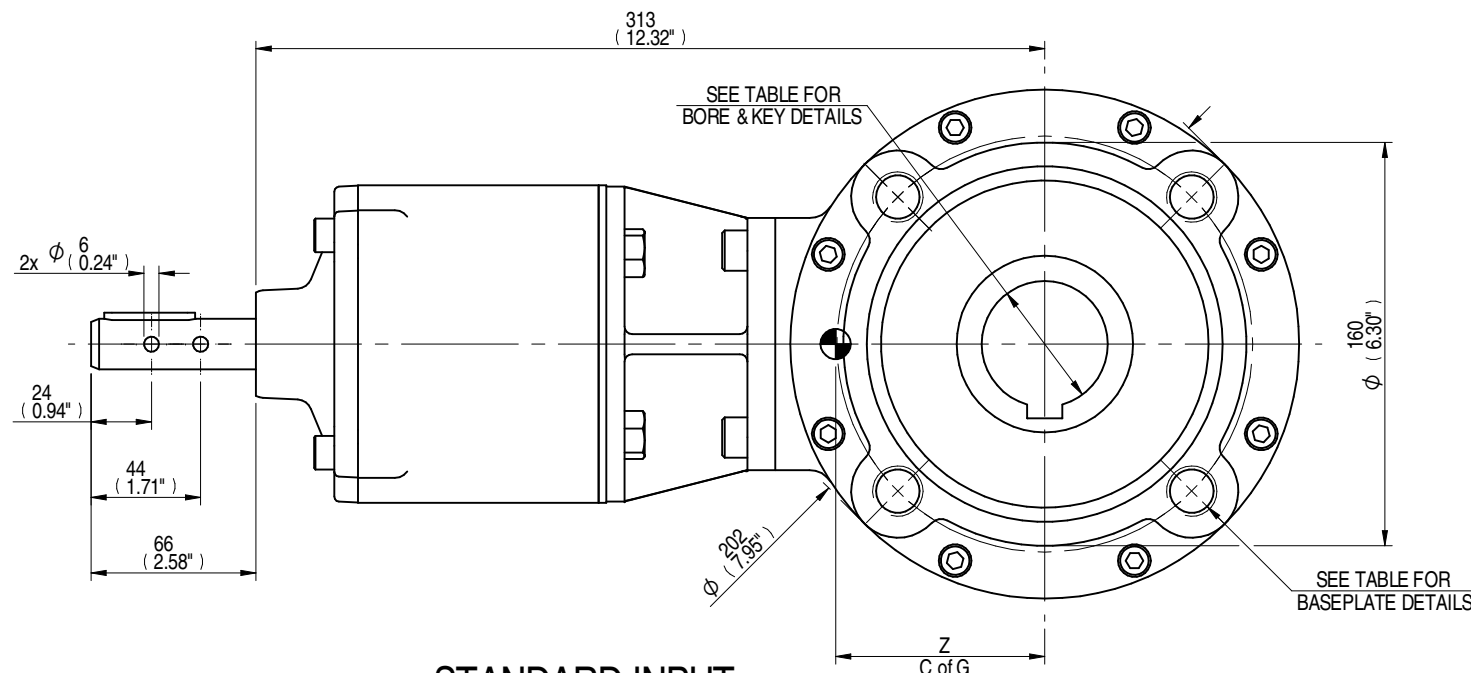

STANDARD INPUT

NOTES:  
MPR IS NOT SUITABLE FOR MOTORISED APPLICATIONS.

COMMON INPUT DETAILS		E-FLANGE INPUT DETAILS			
SHAFT DIA.	KEY DETAILS	FLANGE O/DIA.	RECESS DIA.	RECESS DEPTH	HOLE DETAILS (45° OFF CENTRES)
Ø19.98-0.05	6x6x36	Ø126	Ø70.05+0.05	3	4 HOLES Ø10.5 ON Ø102.0 P.C.
(Ø0.787"-0.002")	(0.24"x0.24"x1.42")	(Ø4.96")	(Ø2.758"+0.002")	(0.12")	4 HOLES Ø0.41" ON Ø4.02" P.C.

MOUNTING HOLES - BOLT CIRCLE (OFF CENTRES)		
STANDARD	SPIGOT DIAMETER	HOLE DETAILS (45° OFF CENTRES)
ISO F16	Ø129.95-0.05 (Ø5.116"-0.002")	4 HOLES M20X25 (0.98") DEEP ON Ø165.0 (Ø6.50") P.C.
FA16	Ø126.87-0.25 (Ø4.995"-0.010")	4 HOLES 3/4"UNCX25 (0.98") DEEP ON Ø165.1 (Ø6.50") P.C.

MAX BORE SQ KEY			MAX BORE RECTANGULAR KEY		MAX. STEM SCREW ACCEPTANCE DIA.
STD	BORE	KEY	BORE	KEY	
BS4235	-	-	52.0	16x10	55 (2.125")
BS46	1.875"	1/2" SQ	2.000"	1/2" x 5/16"	
ANSI B17.1	1.875"	1/2" SQ	2.000"	1/2" x 3/8"	

DESCRIPTION		TORQUE			C of G		
MPR	RATIO	OUTPUT	INPUT	MA	X	Y	Z
MPR4	16.71	850 Nm	70 Nm	12.1	0	25	83

AS PART OF CONTINUOUS PRODUCT DEVELOPMENT, ALL DETAILS SUBJECT TO CHANGE WITHOUT PRIOR NOTICE. FOR UP TO DATE DETAILS PLEASE VISIT [www.rotork.com](http://www.rotork.com)

 <b>LEEDS - UK</b> <a href="http://www.rotork.com">www.rotork.com</a>	This drawing is confidential and is the property of Rotork Gears and must not be reproduced either wholly or partly. All rights in respect of patents, designs and copyrights are reserved. © 2014	Document type <b>PUBLICITY</b> Mass 26.70 kg Dimensions in mm Scale 1:3	Title <b>HOB5 GEARBOX</b> <b>MPR4 MANUAL INPUT REDUCER F16/FA16 OUTPUT</b>
	Created <b>J. DICKINSON</b> <b>22/04/2014</b> Checked <b>T. WITAMORE</b> <b>14/05/2014</b> Approved -	Drawing Number <b>PUB-HOB5MPR4-F16</b>	Rev <b>A</b>
	Sheet <b>1</b> of <b>1</b> Size <b>A3</b>		

Rev	CN	Revised	Approved	Date	Change Description
A	-	-	-	22/04/2014	FIRST ISSUE